

HRCM SERIES

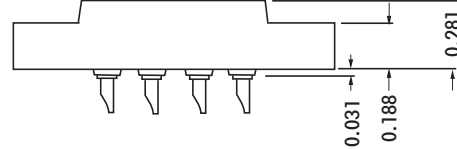

CONTACT DATA		CHASSIS MOUNTING DATA						
		CHASSIS THICKNESS	X-DIMENSION	STYLE	NO. OF CONTACTS	BELOW CHASSIS	BELOW CHASSIS	ABOVE CHASSIS
OPEN ENDED	SOLDER CUP	1/16	.17	I	14	HRCM-1		HRCM-2
				II	16	HRCM-601		HRCM-602
		3/32	.14	I	14		HRCM-31	HRCM-32
				II	16		HRCM-631	HRCM-632
		1/8	.12	I	14		HRCM-41	HRCM-42
				II	16		HRCM-641	HRCM-642
	EYELET	1/16	.17	I	14	HRCM-5		HRCM-6
				II	16	HRCM-605		HRCM-606
		3/32	.14	I	14		HRCM-35	HRCM-36
				II	16		HRCM-635	HRCM-636
		1/8	.12	I	14		HRCM-45	HRCM-46
				II	16		HRCM-645	HRCM-646
STRAIGHT	1/16	.17	I	14			HRCM-4	
			II	16			HRCM-604	
	3/32	.14	I	14				
			II	16				
	1/8	.12	I	14				
			II	16				
CLOSE ENDED	SOLDER CUP	1/16	.17	I	14	HRCM-1K		HRCM-2K
				II	16	HRCM-601K		HRCM-602K
		3/32	.14	I	14		HRCM-31K	HRCM-32K
				II	16		HRCM-631K	HRCM-632K
		1/8	.12	I	14		HRCM-41K	HRCM-42K
				II	16		HRCM-641K	HRCM-642K
	EYELET	1/16	.17	I	14	HRCM-5K		HRCM-6K
				II	16	HRCM-605K		HRCM-606K
		3/32	.14	I	14		HRCM-35K	HRCM-36K
				II	16		HRCM-635K	HRCM-636K
		1/8	.12	I	14		HRCM-45K	HRCM-46K
				II	16		HRCM-645K	HRCM-646K
STRAIGHT	1/16	.17	I	14			HRCM-4K	
			II	16			HRCM-604K	
	3/32	.14	I	14				
			II	16				
	1/8	.12	I	14				
			II	16				

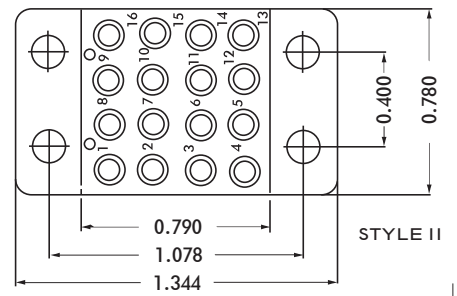
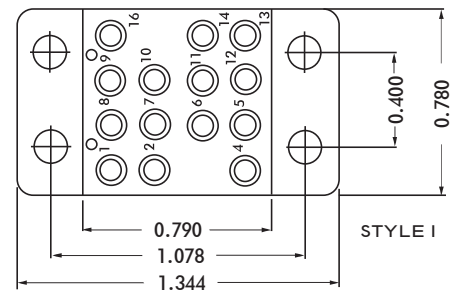
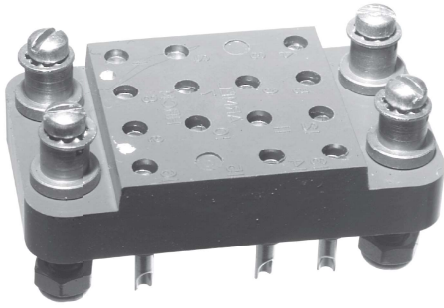
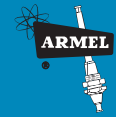
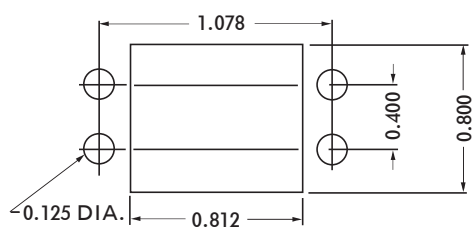

RECOMMENDED CHASSIS CUT-OUT

ELECTRICAL

Wire Size:
 Solder Cup Type One #20 AWG
 Eyelet Type Two #20 AWG or Three #22 AWG

Current Rating 3 Amperes

Withstanding Voltage:
 Contact to Contact Sea Level 2700 VRMS Minimum
 Contact to Ground Sea Level 2250 VRMS Minimum
 Contact to Contact 70,000 Ft. 560 VRMS Minimum
 Contact to Ground 70,000 Ft. 500 VRMS Minimum

MECHANICAL

Creepage Between Contacts 0.17 Minimum
 Air Space Between Contacts 0.11 Minimum
 Contacts to Accept 0.030 ± 0.001 DIA. Pins

Contacts:

Spring Temper Grade "A" Phosphor Bronze, or Heat Treated Beryllium Copper
 Gold Plated over Copper or Nickel Plate

Mounting Hardware:

Special Studs, Screws, Lockwashers, and Nuts

Insulation Material:

Choice of **MIL Approved** Thermosetting Insulations (See Page 45)

Temperature Ratings: -65°C to +125°C

Weight of Socket with Mountings: 0.43 oz.